

| REVISIONS | | | | |
|-----------|-----|-----------------|---------|----|
| ECN# | REV | DESCRIPTION | DATE | BY |
| | A | INITIAL RELEASE | 6/30/17 | HC |

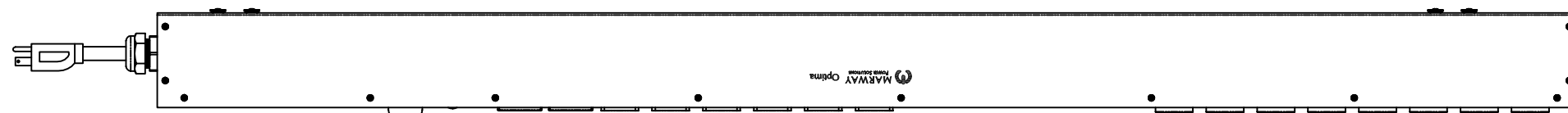

SIDE VIEW

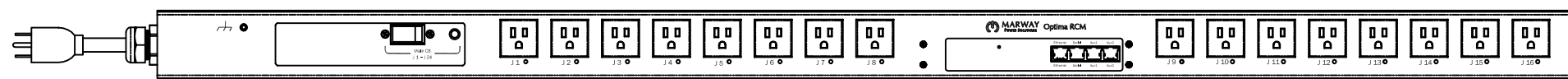

FRONT VIEW

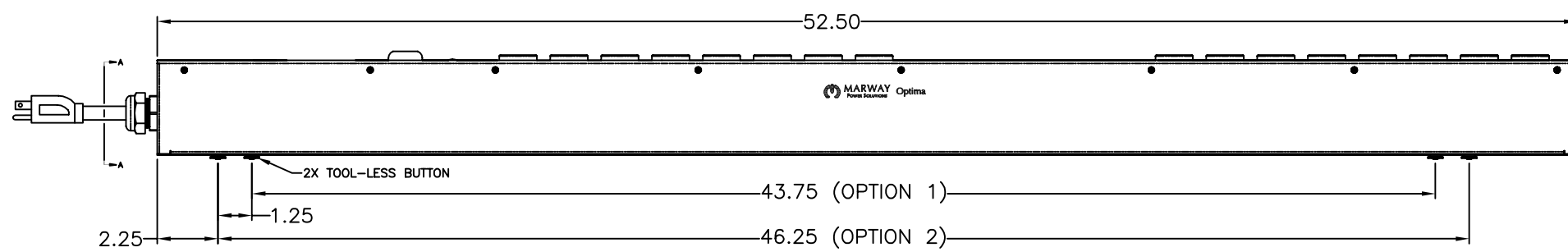

SIDE VIEW

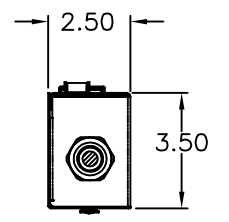

SECTION VIEW A-A

| Configuration | Features | Seq, Srg |
|----------------|-----------------------------|---|
| | Layout | Zero U |
| Input 1 | Voltage | 100-120 Vac, Single Phase, 50/60 Hz |
| | Max Current | 15 Amps |
| | Max Load | 1.44 KVA |
| | Connection | 5-15P, 14 ft cord, 3-wire 14 ga, SJT jacket (Front panel) |
| | Voltage Monitor | None |
| | Current Monitor | None |
| Outlets | All Panels [1][2] | (16) 5-15R, 100-120V (S) |
| Protection | Spike/Surge Suppression [1] | Yes |
| | EMI Filter [1] | None |
| | Over Current [1] | (1) 15A Main Breaker |
| Env Sensors | Temperature | 2 |
| | Humidity | 2 |
| | Interlocks | None |
| | EPO | None |
| Communications | Display | None |
| | Serial | RS-232 (RJ-45) |
| | Ethernet | 10T/100T Auto |
| | Protocols | AlertLog, HTTP, HTTPS, Telnet, SSH, FTP, SMTP, SNMPv2, SNMPv3, SNTP |

| | | |
|-------------|----------------------------|---|
| Physical | Dimensions | 52.5" H x 2.5" W x 3.5" D |
| | Weight | lbs |
| | Materials | Chassis: Steel |
| | Finishes | Chassis: Zinc plated Black, FrontPanel: Zinc plated Black |
| Operating | Temperature | 32°F to 122°F |
| | Humidity | 5 %RH to 85 %RH |
| | Elevation | 25,000 feet |
| Conformance | Warranty | http://www.marway.com/warranty |
| | Safety Certifications | None |
| | Environment Certifications | None |

Notes:
 [1] Certain details of the circuitry may only be revealed by the schematic (available separately)
 [2] S = switched, V = monitored voltage, A = monitored amps

| | | | | | |
|---|-------------------|---|-----|---|--|
| UNLESS OTHERWISE SPECIFIED DIMENSIONS ARE IN INCHES (MILLIMETERS) TOLERANCES ARE: ANGLES ± .5° DECIMALS .006 ± .003 DIMENSIONS .000 ± .010 | | METAL NO. | | SILK NO. | |
| DO NOT SCALE DRAWING | | APPROVALS | | DATE | |
| MATERIAL: | | DRAWN | | 6/30/17 | |
| FINISH: | | CHECKED | | | |
| | | APPROVED | | | |
| PROPRIETARY NOTICE THE INFORMATION CONTAINED IN THIS DRAWING IS THE SOLE PROPERTY OF MARWAY POWER SOLUTIONS. ANY REPRODUCTION IN PART OR AS A WHOLE WITHOUT THE WRITTEN PERMISSION OF MARWAY POWER SOLUTIONS IS STRICTLY PROHIBITED. | | 1721 S. GRAND AVE. SANTA ANA, CA 92705 PH: (714) 917-6200 FX: (714) 917-6253 | | SPECIFICATION DRAWING-- MPD 829013-NSW-000 | |
| SIZE | CAGE CODE | DWG NO. | REV | | |
| D | 60955 | 829013-NSW-000 | A | | |
| SCALE | COMPUTER FILE NO. | P829013-NSW-000 REV A SHEET 1 OF 1 | | | |
| NONE | | | | | |