

REVISIONS				
ECO#	REV	DESCRIPTION	DATE	BY
	A	INITIAL RELEASE	7/16/10	HC

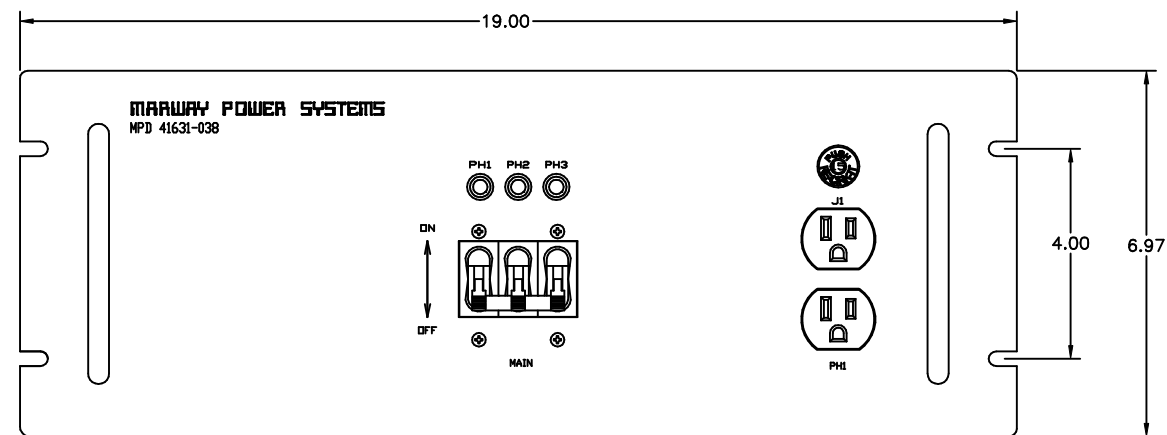

FRONT VIEW

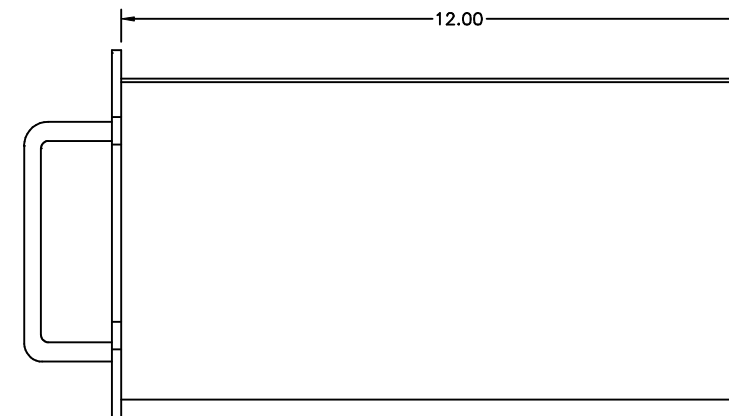

SIDE VIEW

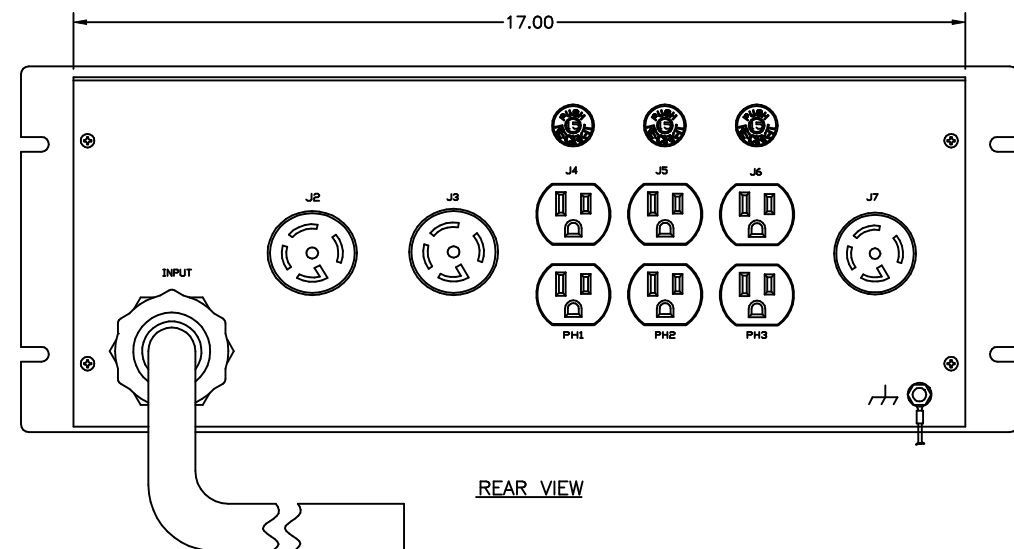

REAR VIEW

Configuration	Type	Basic
	Layout	4 U
Input 1	Voltage	120/208 VAC, 3-Phase Wye, 50/60 Hz
	Max Current	100 Amps
	Max Load	9.60 KVA, 28.78 KVA
	Connection	Pigtail, 14 ft cord, 5-wire 2 ga, SO jacket (Rear panel)
	Voltage Monitor	None
	Current Monitor	None
Outlets	All Panels [1][2]	(8) 5-15R, 120V (3) L21-30R, 120/208V
Protection	Spike/Surge Suppression [1]	Yes
	EMI Filter [1]	Yes
	Over Current [1]	(4) 15A Circuit Breaker (1) 100A Circuit Breaker
Env Sensors	Temperature	None
	Humidity	None
	Interlocks	None
	EPO	None
Communications	Display	None
	Serial	None
	Ethernet	None
	Protocols	None

Physical	Dimensions	4 U x 19" W x 12" D
	Weight	lbs
	Materials	Chassis: Steel
	Finishes	Chassis: Zinc plated Gold, FrontPanel: Painted Gray
Operating	Temperature	32°F to 122°F
	Humidity	5 %RH to 85 %RH
	Elevation	25,000 feet
Conformance	Warranty	<a href="http://www.marway.com/warranty">http://www.marway.com/warranty</a>
	Safety Certifications	None
	Environment Certifications	None

Notes:

[1] Certain details of the circuitry may only be revealed by the schematic (available separately)

[2] S = switched, V = monitored voltage, A = monitored amps

PROPRIETARY NOTICE

ALL PATENT OR OTHER PROPRIETARY RIGHTS PERTAINING TO THE ITEMS SOLD HERE UNDER SHALL REMAIN THE SOLE PROPERTY OF MARWAY POWER SOLUTIONS EXCEPT THAT THE PURCHASER SHALL HAVE THE RIGHT TO USE SUCH ITEMS FOR THEIR INTENDED PURPOSE.

UNLESS OTHERWISE SPECIFIED DIMENSIONS ARE IN INCHES TOLERANCES ARE: ANGLES DECIMALS ± 1/2" .005 ± .03 ± .000 ± .010 DO NOT SCALE DRAWING		METAL NO.		SILK NO.	
APPROVALS		DATE		DRAWN	
MATERIAL:		CHECKED		7/16/10	
FINISH:		APPROVED			
SCALE: NONE		FSCM NO. 60955		DWG NO. 41631-038	
P41631-038 REV A		SHEET 1 OF 1		REV A	

**MARWAY** 17500 GILLETTE AVE.  
IRVINE, CA 92614  
Ph (714) 917-6200  
FAX (714) 917-6253  
TOLL FREE 800 462-7929

**POWER SOLUTIONS**

SPECIFICATION DRAWING—  
MPD 41631-038