

REVISIONS				
ED#	REV	DESCRIPTION	DATE	BY
	A	INITIAL RELEASE	8/30/11	HC

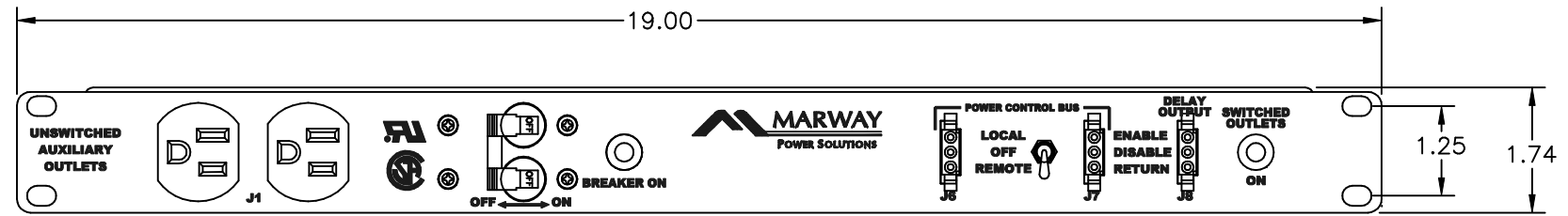

FRONT VIEW

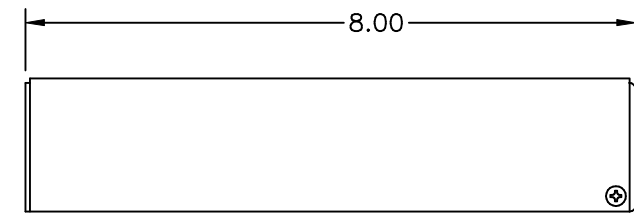

SIDE VIEW

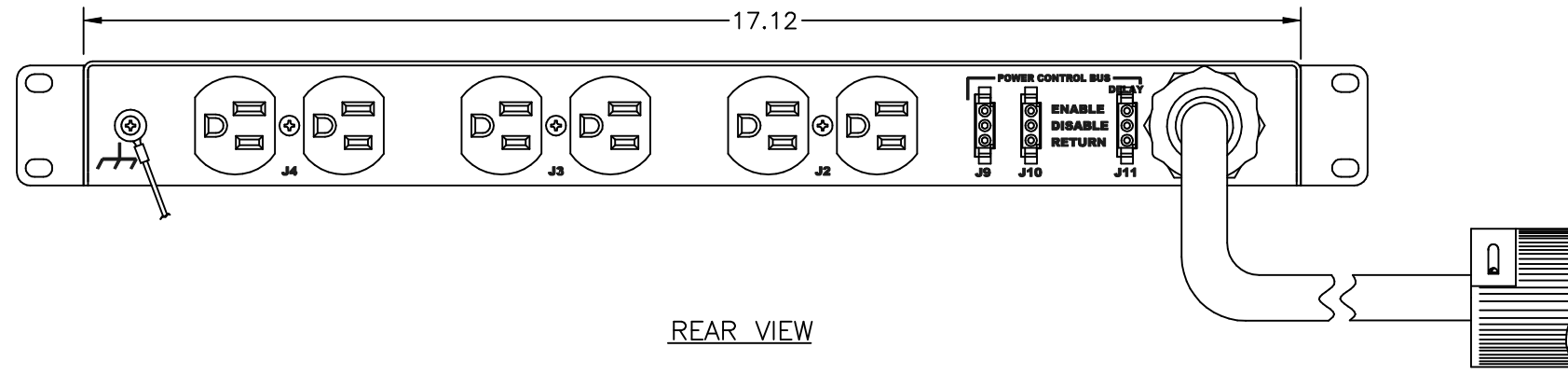

REAR VIEW

Configuration	Type	Basic
	Layout	1 U
Input 1	Voltage	120 VAC, Single Phase, 50/60 Hz
	Max Current	20 Amps
	Max Load	1.92 KVA
	Connection	L5-20P, 10 ft cord, 3-wire 12 ga, SO jacket (Rear panel)
	Voltage Monitor	None
	Current Monitor	None
Outlets	All Panels [1][2]	(2) 5-15R, 120V (6) 5-15R, 120V (S)
Protection	Spike/Surge Suppression [1]	Yes
	EMI Filter [1]	Yes
	Over Current [1]	(1) 20A Main Breaker
Env Sensors	Temperature	None
	Humidity	None
	Interlocks	None
	EPO	None
Communications	Display	None
	Serial	None
	Ethernet	None
	Protocols	None

Physical	Dimensions	1 U x 19" W x 8" D
	Weight	lbs
	Materials	Chassis: Steel
	Finishes	Chassis: Zinc plated Gold, FrontPanel: Zinc plated Gold
Operating	Temperature	32°F to 122°F
	Humidity	5 %RH to 85 %RH
	Elevation	25,000 feet
Conformance	Warranty	<a href="http://www.marway.com/warranty">http://www.marway.com/warranty</a>
	Safety Certifications	UL, CSA
	Environment Certifications	None
Notes:		
		[1] Certain details of the circuitry may only be revealed by the schematic (available separately)
		[2] S = switched, V = monitored voltage, A = monitored amps

UNLESS OTHERWISE SPECIFIED DIMENSIONS ARE IN INCHES TOLERANCES ARE: ANGLES DECIMALS X.XX ± .03 XXX ± .010 DO NOT SCALE DRAWING	MATERIAL:				1721 S. GRAND AVE. SANTA ANA, CA 92705 PH: (714) 917-8200 FX: (714) 917-8253
	FINISH:				
APPROVALS		METAL NO.	SILK NO.	DATE	
DRAWN		HC		8/30/11	
CHECKED					
APPROVED					
THE INFORMATION CONTAINED IN THIS DRAWING IS THE SOLE PROPERTY OF MARWAY POWER SOLUTIONS. ANY REPRODUCTION IN PART OR AS A WHOLE WITHOUT THE WRITTEN PERMISSION OF MARWAY POWER SOLUTIONS IS STRICTLY PROHIBITED.		SCALE	COMPUTER FILE NO.	SIZE	CAGE CODE
				D	60955
				DWG NO.	P100R-002
				REV	A
				P100R-002 REV A SHEET 1 OF 1	